



## LAUNDRY CARRIER

Hailo Laundry-Carrier 600

For 60 cm wide base-cabinets



SLIDE



4 BUCKET

80 l

TOTAL

FOR CABINET WIDTH:

60 cm

### SPECIFICATIONS Art.nr. I-TKS-600-550

Type of installation	Slide	yes
Cabinet-width min. (cm)		60
Cabinet-width max. (cm)		60
available Cabinet-depth min. (mm)		530
Sidewall mounted		yes
Slides		covered, dampened slides with self-closing device with over-travel
Side-wall thickness (mm)		16 - 19 mm (self-adjusting)
Product dimensions (WxDxH) (mm)		562 - 568 x 528 x 545
Packing dimensions (WxDxH) (mm)		590 x 325 x 620
System-depth (mm)		528
Number of bins		4
Capacity (l)		2 x 33 + 1 x 12 + 1 x 2,5
Total volume (l)		80
Color metal parts		white
Color plastic parts		white / light-blue
Weight incl. packing (kg)		14,9

### SKETCHES

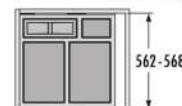
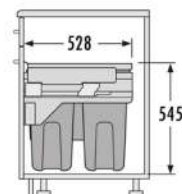

Marknadsförs i Sverige av

**LINFALK**  
BESLAG & INREDNING

Tel. 013 - 31 40 20  
E-post: [info@linfalk.se](mailto:info@linfalk.se)

[www.linfalk.se](http://www.linfalk.se)



## LAUNDRY CARRIER

Hailo Laundry-Carrier S 600

For 60 cm wide base-cabinets



SLIDE



2 BUCKET

66 l

TOTAL

FOR CABINET WIDTH:

60 cm

### SPECIFICATIONS Art.nr. I-TKS-600-450

Type of installation	Slide	yes
Cabinet-width min. (cm)		60
Cabinet-width max. (cm)		60
available Cabinet-depth min. (mm)		450
Sidewall mounted		yes
Slides		covered, dampened slides with self-closing device with over-travel
Side-wall thickness (mm)		16 - 19 mm (self-adjusting)
Product dimensions (WxDxH) (mm)		562 - 568 x 448 x 545
Packing dimensions (WxDxH) (mm)		590 x 325 x 620
System-depth (mm)		448
Number of bins		2
Capacity (l)		2 x 33
Total volume (l)		66
Weight incl. packing (kg)		12,5

### SKETCHES

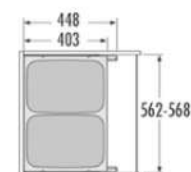
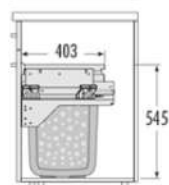
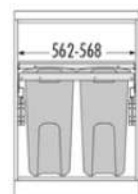

Marknadsförs i Sverige av

**LINFALK**  
BESLAG & INREDNING

Tel. 013 - 31 40 20  
E-post: [info@linfalk.se](mailto:info@linfalk.se)

[www.linfalk.se](http://www.linfalk.se)



## LAUNDRY CARRIER

Hailo Laundry-Carrier 500

For 50 cm wide base-cabinets



SLIDE



2 BUCKET

66 l

TOTAL

FOR CABINET WIDTH:

50 cm

### SPECIFICATIONS Art.nr. I-TKS-500-550

Type of installation	Slide	yes
Cabinet-width min. (cm)		50
Cabinet-width max. (cm)		50
available Cabinet-depth min. (mm)		530
Sidewall mounted		yes
Slides		covered, dampened slides with self-closing device with over-travel
Side-wall thickness (mm)		16 - 19 mm (self-adjusting)
Product dimensions (WxDxH) (mm)		462 - 468 x 528 x 545
Packing dimensions (WxDxH) (mm)		490 x 320 x 620
System-depth (mm)		528
Number of bins		2
Capacity (l)		2 x 33
Total volume (l)		66
Color metal parts		white
Color plastic parts		white / light-blue
Weight incl. packing (kg)		12,7

### SKETCHES



Marknadsförs i Sverige av

**LINFALK**  
BESLAG & INREDNING

Tel. 013 - 31 40 20  
E-post: info@linfalk.se

www.linfalk.se

# HFO Libero 2.0

Electronic Door-Opener

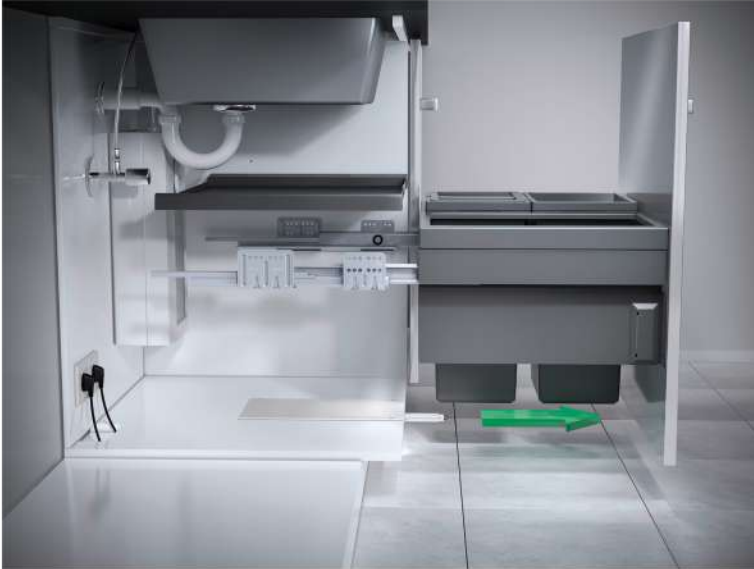

## DESCRIPTION Art.nr. I-HFO

- For base cabinets from 300mm to 1200mm (12 in. to 48 in.) widths
- Mounts in forward section of bottom-panel
- Can also easily be retrofitted
- Low Voltage device, 5 V input, comes with Micro-USB socket
- Power supply by mobile-phone charger/ transformer for 110 V thru 230 V outlets, with 2m Micro-USB/ USB cable and international adapters
- Easy operation by foot sensor (or by optional remote control)
- Integrated location lighting, may be dimmed and switched off
- Push-out force adjustable
- No unintended opening
- Intelligent controls, identifies obstacles thanks to friction clutch
- Splash-water proof according to IP 21 certification
- Comes with European, British, and North American Certifications
- Settings and Adjustments via Hailo Smart-Phone App for Android and IOS
- Independent WLAN, secured against access from www.
- Developed and Made in Germany

Marknadsförs i Sverige av

**LINFALK**  
BESLAG & INREDNING

Tel. 013 - 31 40 20  
E-post: [info@linfalk.se](mailto:info@linfalk.se)

[www.linfalk.se](http://www.linfalk.se)

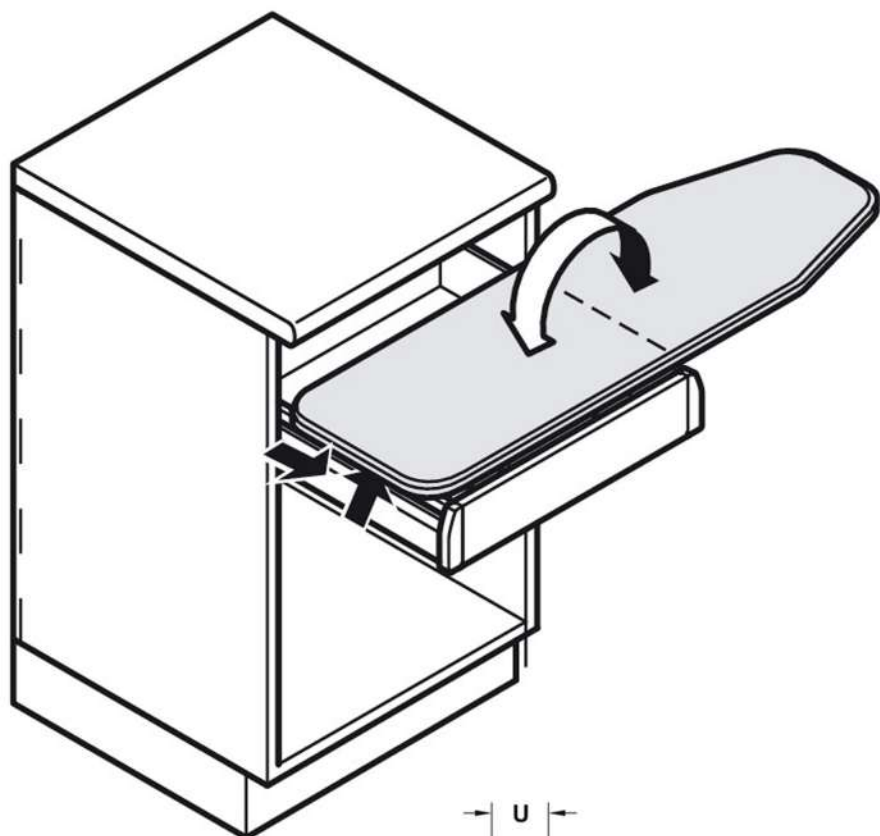

# Strykbräda för montering i låda

Art.nr. I-ST964LÅD

Stomme 500 & 600mm

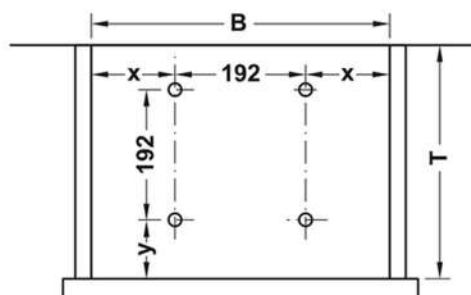
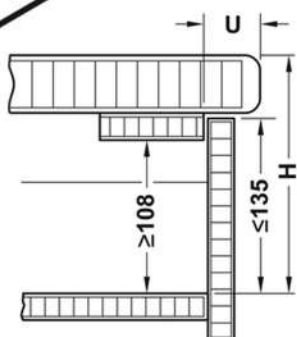

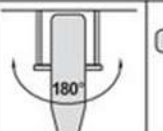
			
<b>Internal drawer width B mm</b>	≥498	≥406	≥506
<b>Internal drawer opening depth T mm</b>	≥435	≥500	≥320
<b>Dim. H mm</b>	–	≤155	≤155
<b>Dim. y mm</b>	≥59	≥150	≥57
<b>Dim. x mm</b>	≥153	≥182/≥32 (left/right)	>277/≥37 (left/right)
<b>Overlay U</b>	≤38	≤25	≤38
<b>Cabinet width mm</b>	600	500	600
<b>Nominal length mm</b>	500	550	400